

# **BERA** GRAVEL FIX<sup>®</sup> *smart*

Gravel Stabilization System



**BERA**<sup>®</sup>

## What is BERA Gravel Fix® Smart?

BERA Gravel Fix® Smart is an advanced recyclable stabilization system for gravel. With its hexagonal honeycomb-like structure of high quality Polypropylene cells, BERA Gravel Fix® Smart is designed to provide a strong and stable sub-base for the application of gravel on paths, driveways, car parks and roofs. It will facilitate a strong and porous surface for residential projects.

### Applications:

- 👉 Gardens and terraces
- 👉 Parking and gravel driveways

### Features and benefits of BERA Gravel Fix® Smart:

- 👉 Easy to install & stable gravel surface in fast and economic way
- 👉 For pedestrian and vehicle use, even trucks
- 👉 Easy mobility for all including those wearing high-heels or with bicycles, motorbike or wheelchair
- 👉 Terrace furniture, ladders – stable and no sinking in
- 👉 Fully porous, so dry and ensuring infiltration of rainwater immediately

### Did You Know?

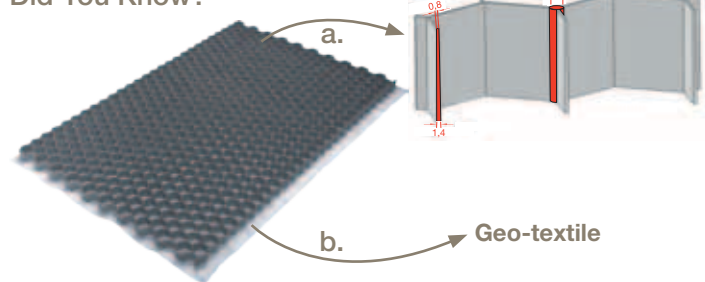

- BERA Gravel Fix® Smart has 32 mm deep, tapered cell walls of 1.4 mm at the base and 0.8 mm at the top to ensure the highest vertical strength. The ultrasonic welding process adds to the lateral strength for use on sloped areas.
- A strong geo-textile is fitted to reduce weed growth and keep the gravel in their cells.

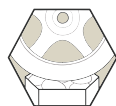

📌 For your vehicle use and parkings



📌 For maximum mobility and stability on path and walkways



📌 For green roofing with sedum or stable base for (roof) terraces



📌 BERA Gravel Fix® Smart manufactured by **GREEN** solar and biomass power



📌 UV stabilisation included

## TECHNICAL SPECIFICATIONS\*

### GENERAL

Material	: 100% recycled or pure Polypropylene (recyclable)
Manufacturing technique	: High Precision Injection Moulding
Manufacturing standards	: ISO9001, 16949 Lloyds, REACH
Manufacturing location	: European Union
Colour	: White, grey or black
Cell structure	: Hexagonal
Membrane	: Geo-textile 30 g/m <sup>2</sup>
UV and frost	: UV and frost resistant

### PHYSICAL DATA

Standard sheet size L x W x H	: 392 x 764 x 32 mm (0.3 m <sup>2</sup> )
Cell size	: 42 mm diameter
Wall thickness tapered	: 0.8 - 1.4 mm (top - bottom)
Weight per piece / m <sup>2</sup>	: 0.51 / 1.53 kg
Gravel required per m <sup>2</sup>	: 50 litre or 75 kg
Vertical strength, empty	: 120T/m <sup>2</sup> (pure PP) 95 T/m <sup>2</sup> (100% recycled PP)
Vertical strength, filled	: depending on gravel 250 – 450 T/m <sup>2</sup>

\* All data is subject to change without prior notice by the manufacturer

BERA® Gravel Fix® Smart is frequently used on light slopes including driveways. Specific requirements on the application depend on the circumstances on site. Please contact the manufacturer or the dealer for further advise.

## Environmental and Engineering Excellence



BERA Gravel Fix® Smart is manufactured in the European Union under stringent Quality and Environmental Control standards, including REACH (EC 1907/2006). The use of recycled raw materials and well developed infrastructure to minimize our delivery carbon footprint, underline our corporate vision in providing environmentally sustainable solutions.

## BERA Gravel Fix® Smart, a sustainable product:

- 🌱 Manufactured in Europe using renewable energy sources
- 🌱 Fully recyclable after end of life-cycle
- 🌱 Select 100% recycled raw materials at no extra cost
- 🌱 Safety according REACH (EC1907/2006)
- 🌱 UV and frost resistant
- 🌱 No glue, only thermally welded connections
- 🌱 Social awareness policy



# LAYING INSTRUCTIONS

For path	Vehicle use
	
1.5 cm gravel 3.2 cm BERA GRAVEL FIX® with gravel	1.5 cm gravel 3.2 cm BERA GRAVEL FIX® with gravel
10 cm sand	4 - 6 cm sand 15 - 25 cm crushed stone



## FOUNDATION

Foundation profile to be determined by site conditions and suitable for anticipated load. In general the foundation shall be:  
For paths only: a flat layer of 10 cm sharp sand.  
For vehicle use: a compacted layer of 15-25 cm MOT (crushed stone) plus 4-6 cm sharp sand.

## SHAPING

Create shape using border systems in aluminium, Corten or galvanized steel, wood or plastic. Height (5-15 cm) and thickness depending on expected load. Use laser height determination for alignment with surrounding area.

## COMPACTING

A stable, well compacted base, as used in all other paving methods, is essential. Failure may lead to non-performance of BERA Gravel Fix® Smart as intended.

## LEVELING

After compacting, level the sand layer eliminating any surplus sand. Remove any debris or sharp items from the sand layer.

## LAYING

Each sheet has extended geo-textile lips on 2 sides. Lay the sheets onto the extended geo-textile lip of the adjacent sheet for maximum stability, weed control and support.

## TRIMMING

Cut to fit to edging or obstacles using hand or electric tools to ensure sheets are firmly fixed within the edges. Important: Please follow tool manufacturers safety instructions.

## FILLING

Fill the sheets with gravel, between 3-16 mm, which should exceed the height of the cell wall by 15-20 mm. (refer to our Technical Documentation for further details).

## FINISHING

Rake the gravel to distribute evenly. Maintenance is limited to raking and removing leaves and other debris. Important: Keep the sheets covered with gravel for maximum durability. Top-up gravel as and when required to keep the sheets covered.





**B**ERA® is the trademark of BERA B.V. of The Netherlands, a company which develops stabilization systems, eco systems and prestigious outdoor living concepts.

With the company's historical roots & wealth of know-how in landscaping and architectural fields, they create innovative and environmentally sustainable solutions, supplied throughout Europe, the Middle-East, South Africa and S-E Asia regions.

#### Contact:

BERA B.V. (The Netherlands)  
T: +31 (0) 33 257 0302  
E: [info@bera-bv.com](mailto:info@bera-bv.com)

BERA B.V. (Germany)  
T: +49 (0) 30 78 71 68 85  
E: [kontakt@bera-bv.com](mailto:kontakt@bera-bv.com)

BERA Sarl (France)  
T: +33 (0) 9 81 12 76 58  
E: [info@bera-sarl.fr](mailto:info@bera-sarl.fr)

BERA B.V. (Africa)  
T: +27 83 449 3954  
E: [franko@bera-bv.com](mailto:franko@bera-bv.com)

[www.bera-bv.com](http://www.bera-bv.com)

